



CaretronTM
Made for You

INDOASIANTM
MAKES SENSE

Indo Asian is not a new name when it comes to safeguarding your happiness. With over 60 years of experience, we are a trusted brand that has changed with the changing global conditions. Indo Asian provides complete protection through an extensive range of products.

As believers of innovation, we give you products with quality and performance that offer value for your money. Our Caretron range has been designed specifically after studying the global electrical needs, to give modern world the protection it deserves.

Crafted with quality components and innovative technology, Caretron lives up to its name by ensuring a shock-free environment for global homes, and treating your electrical goods with the care they need. A combination of quality design and value for money, Caretron is a sensible choice that has been made just for You.

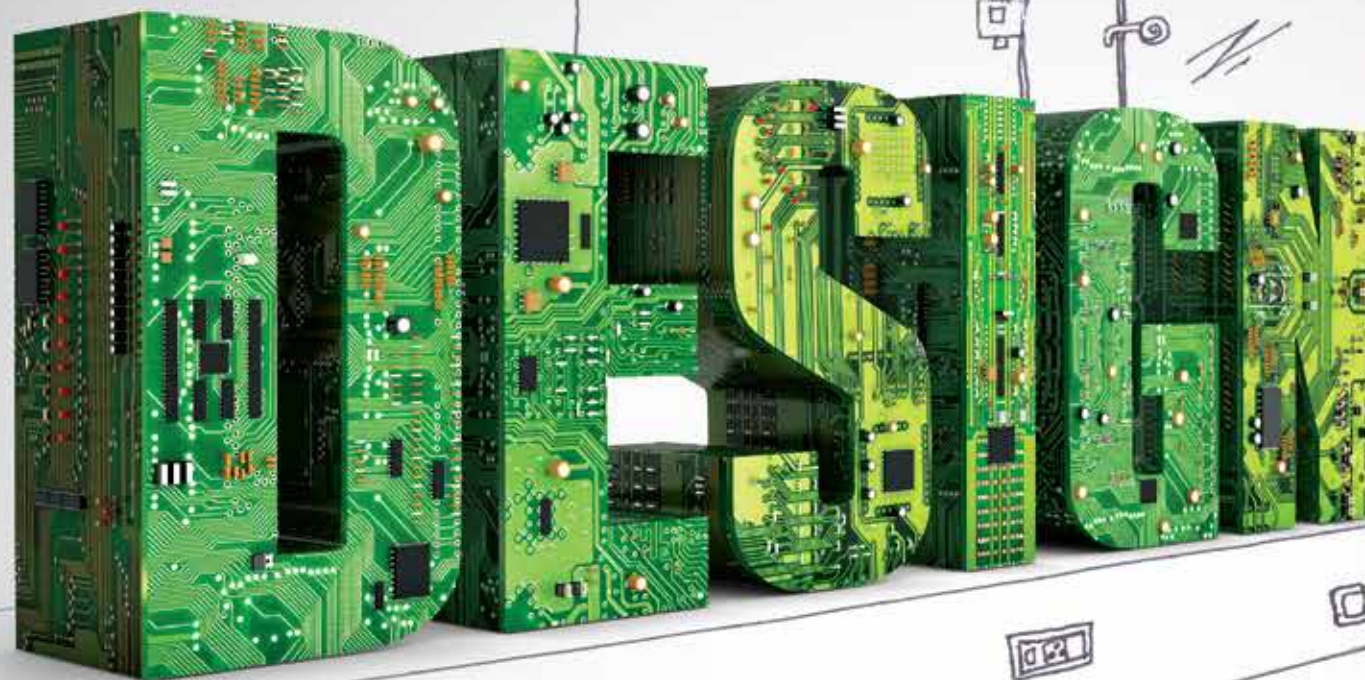

It's great when you can make something exactly as per your requirements, whether it's a project or a protection range. Caretron has been crafted keeping in mind the current global needs and conditions. Using quality components and latest technologies, our Caretron protection range has been designed to be durable and sturdy.



In this fast-paced life, we understand the importance of safety. While one speeds ahead on the roads of daily struggles and progress, wearing a helmet ensures safety and protection. Just like a helmet, the new Caretron range is built to ensure a safe and protected environment.



After a certain age, it's our experience that speaks for us. Having known the world and witnessed the change, we know what to trust. Just like a walking stick- the one thing we don't mind relying on, because it supports us and is our everyday reliance. Similarly, Indo Asian, with its extensive experience has been reinventing itself, staying reliable and relevant in the changing global conditions. Staying up-to-date, we now present the Caretron range, engineered specifically to match the requirements of new world.



Whether you're a child buying a balloon or an adult contemplating electrical protection, it's always best to have a variety of products to meet your every requirement. For protection requirements, Caretron offers you a wide spectrum of products ranging from MCBs, Isolators to RCCBs, ensuring complete and all-round protection.

Caretron Features

Range

The Caretron range offers you a wide variety of products like MCBs, Isolators and RCCBs, ensuring end-to-end safety.



CE Marking

The CE marking on our Caretron range guarantees the quality tests our products have been through, making it a dependable choice.



Improved Mechanism

The Caretron range promises quality at a reasonable price. Its simple design and fine quality components assure long-lasting performance.



IP 20 Protected Terminals

Understanding the importance of safety, our Caretron range is built in such a way, that all the active and live parts are away from human reach, ensuring operator's safety.

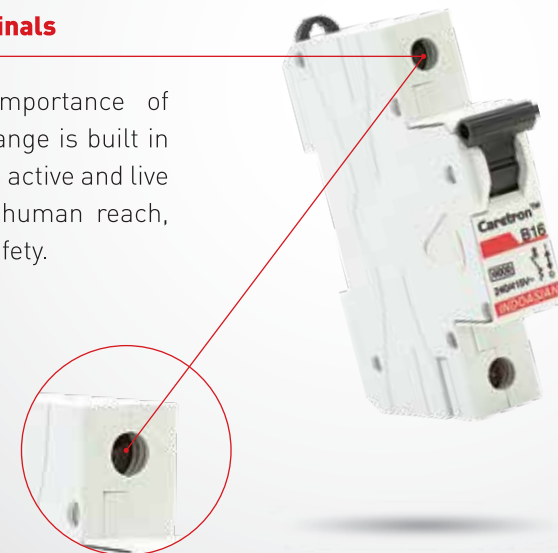

Caretron Features

Bi- Connect Terminals

The Caretron range provides flexibility when it comes to connection. It gives you the option to connect either by using a busbar or a cable.



Clear Markings

The Caretron range has been printed using the latest technology to give a clear and a long-lasting front face marking. The technical parameters, On/Off symbols along with the brand and the range name, have been clearly marked on the entire range. This marking also helps enhance the design appeal of this range.



Dual Position Clamp

The dual position clamp on the top of our Caretron range provides ease of installation. The ergonomically designed clamp is long-lasting and durable.



Terminal Size

The terminal size in our Caretron range is adaptive to cable size up to 25 sq mm. It offers convenience and flexibility while wiring. The terminals are designed to hold cables tightly which avoids loose connection.



Energy Efficiency



| Circuit breakers B and C curves | | | | | | | | | |
|---------------------------------|------|-----|------|-----|-----|-----|-----|-----|-----|
| Rated Current | 06A | 10A | 16 A | 20A | 25A | 32A | 40A | 50A | 63A |
| Caretron Power Loss (Watt) | 0.85 | 1.7 | 2.7 | 2.6 | 2.4 | 4.4 | 4.5 | 5.5 | 6.5 |
| As per IS/IEC 60898-1 | 3 | 3 | 3.5 | 4.5 | 4.5 | 6 | 7.5 | 9 | 13 |

De-rating of circuit-breakers:

| | Ambient Temperature / In | | | | | | | | | |
|--------|--------------------------|-------|------|------|------|------|------|------|------|------|
| In (A) | - 25°C | -10°C | 0°C | 10°C | 20°C | 30°C | 40°C | 50°C | 60°C | 70°C |
| 6 | 7.5 | 7 | 6.6 | 6.4 | 6.2 | 6 | 5.8 | 5.6 | 5.4 | 5.3 |
| 10 | 12.5 | 11.5 | 11.1 | 10.7 | 10.3 | 10 | 9.7 | 9.3 | 9 | 8.7 |
| 16 | 20 | 18.7 | 18 | 17.3 | 16.6 | 16 | 15.4 | 14.7 | 14.1 | 13.5 |
| 20 | 25 | 23.2 | 22.4 | 21.6 | 20.8 | 20 | 19.2 | 18.4 | 17.6 | 16.8 |
| 25 | 31.5 | 29.5 | 28.3 | 27.2 | 26 | 25 | 24 | 22.7 | 21.7 | 20.7 |
| 32 | 41 | 37.8 | 36.5 | 34.9 | 33.3 | 32 | 30.7 | 29.1 | 27.8 | 26.5 |
| 40 | 51 | 48 | 46 | 44 | 42 | 40 | 38 | 36 | 34 | 32 |
| 50 | 64 | 60 | 57.5 | 55 | 52.5 | 50 | 47.5 | 45 | 42.5 | 40 |
| 63 | 80.6 | 75.6 | 72.5 | 69.9 | 66.1 | 63 | 59.8 | 56.1 | 52.9 | 49.7 |

Reference temperature: 30°C according to standard IS/IEC 60898-1

Technical Characteristics

Tripping Characteristics Curve: Type - B & C

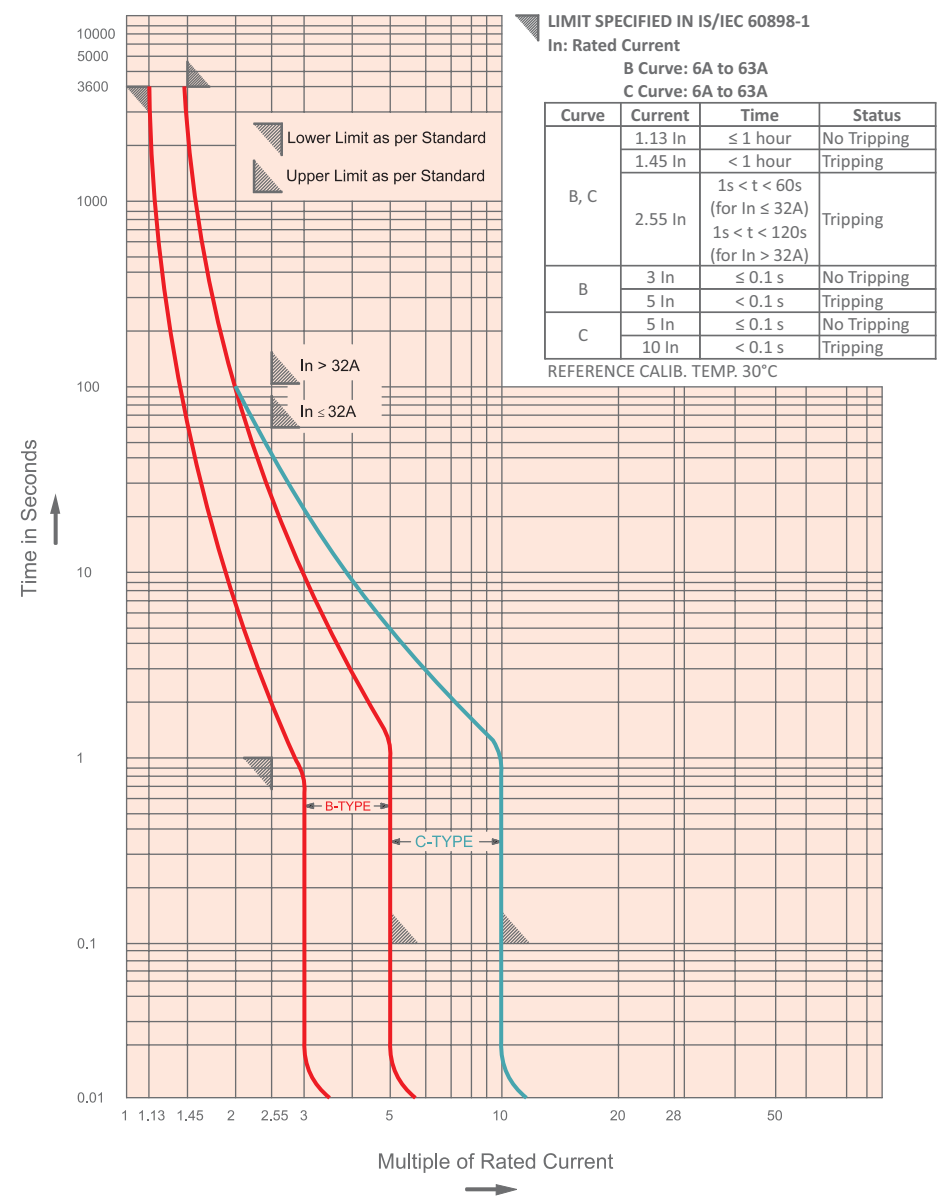

Dimensions

Miniature Circuit Breaker & Isolator

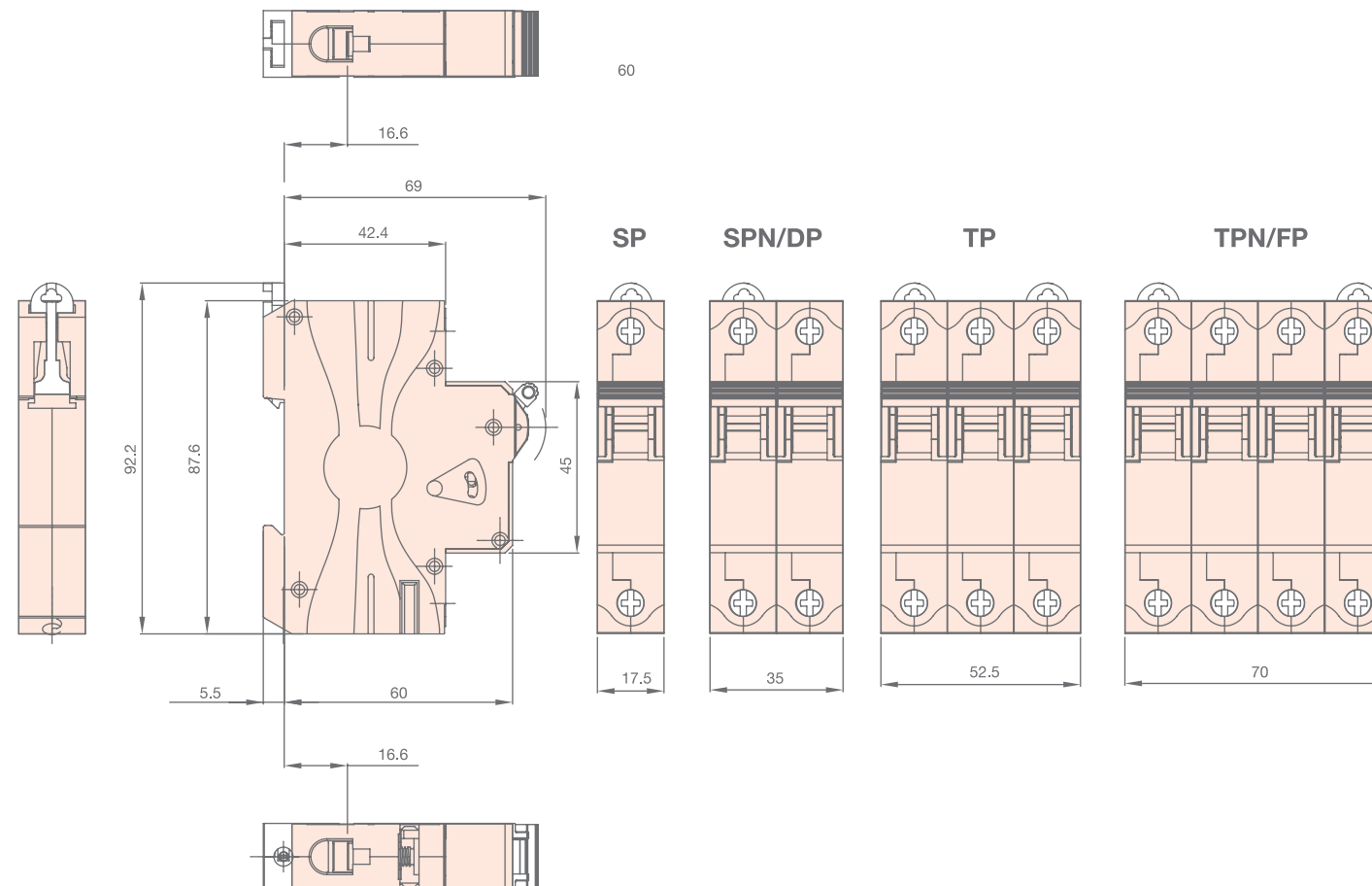

Dimensions

Residual Current Circuit Breaker

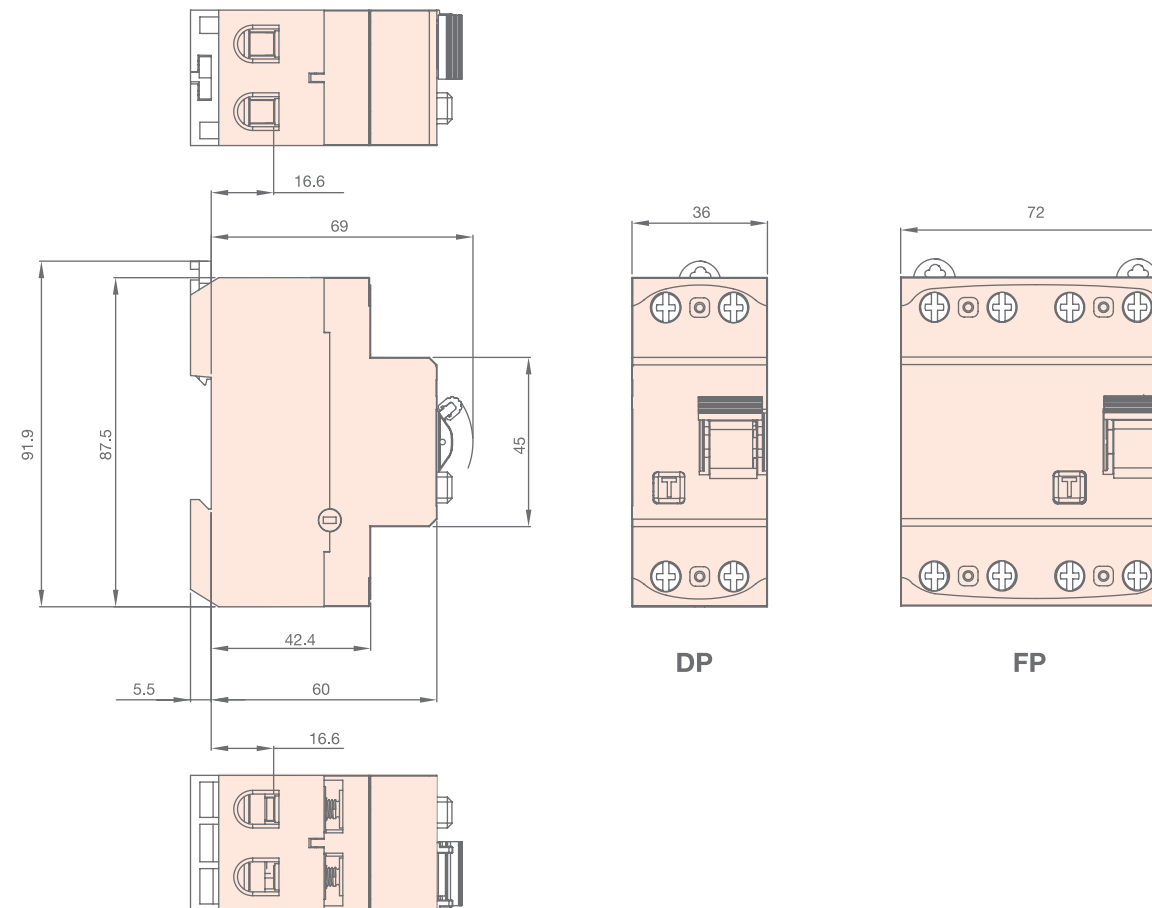



Miniature Circuit Breaker - MCB

- Confirms to IEC 60898 -1
- Degree of Protection IP 20
- 25 sq. mm Terminals
- Breaking Capacity 6kA
- CE marked
- Bi-Connect Terminals
- Positive Isolation
- Frequency 50Hz
- Operating Voltage 240V / 415V AC, 60V DC per Pole

|  <p>B Curve Single Pole</p> | Cat. Nos. | Rating (A) | Pack |
|-------------------------------------------------------------------------------------------------------------------------|-----------|------------|----------|
| | 810000 | 6 | 1/12/120 |
| | 810001 | 10 | 1/12/120 |
| | 810002 | 16 | 1/12/120 |
| | 810003 | 20 | 1/12/120 |
| | 810004 | 25 | 1/12/120 |
| | 810005 | 32 | 1/12/120 |
| | 810006 | 40 | 1/12/120 |
| | 810007 | 50 | 1/12/120 |
| | 810008 | 63 | 1/12/120 |

|  <p>B Curve Double Pole</p> | Cat. Nos. | Rating (A) | Pack |
|---------------------------------------------------------------------------------------------------------------------------|-----------|------------|--------|
| | 810018 | 6 | 1/6/60 |
| | 810019 | 10 | 1/6/60 |
| | 810020 | 16 | 1/6/60 |
| | 810021 | 20 | 1/6/60 |
| | 810022 | 25 | 1/6/60 |
| | 810023 | 32 | 1/6/60 |
| | 810024 | 40 | 1/6/60 |
| | 810025 | 50 | 1/6/60 |
| | 810026 | 63 | 1/6/60 |

|  <p>B Curve Single Pole Neutral</p> | Cat. Nos. | Rating (A) | Pack |
|-----------------------------------------------------------------------------------------------------------------------------------|-----------|------------|--------|
| | 810009 | 6 | 1/6/60 |
| | 810010 | 10 | 1/6/60 |
| | 810011 | 16 | 1/6/60 |
| | 810012 | 20 | 1/6/60 |
| | 810013 | 25 | 1/6/60 |
| | 810014 | 32 | 1/6/60 |
| | 810015 | 40 | 1/6/60 |
| | 810016 | 50 | 1/6/60 |
| | 810017 | 63 | 1/6/60 |

|  <p>C Curve Single Pole</p> | Cat. Nos. | Rating (A) | Pack |
|-----------------------------------------------------------------------------------------------------------------------------|-----------|------------|----------|
| | 810054 | 6 | 1/12/120 |
| | 810055 | 10 | 1/12/120 |
| | 810056 | 16 | 1/12/120 |
| | 810057 | 20 | 1/12/120 |
| | 810058 | 25 | 1/12/120 |
| | 810059 | 32 | 1/12/120 |
| | 810060 | 40 | 1/12/120 |
| | 810061 | 50 | 1/12/120 |
| | 810062 | 63 | 1/12/120 |

Miniature Circuit Breaker - MCB

- Confirms to IEC 60898 -1
- Degree of Protection IP 20
- 25 sq. mm Terminals
- Breaking Capacity 6kA
- CE marked
- Bi-Connect Terminals
- Positive Isolation
- Frequency 50Hz
- Operating Voltage 240V / 415V AC, 60V DC per Pole



**C Curve
Single Pole Neutral**

| Cat. Nos. | Rating (A) | Pack |
|-----------|------------|--------|
| 810063 | 6 | 1/6/60 |
| 810064 | 10 | 1/6/60 |
| 810065 | 16 | 1/6/60 |
| 810066 | 20 | 1/6/60 |
| 810067 | 25 | 1/6/60 |
| 810068 | 32 | 1/6/60 |
| 810069 | 40 | 1/6/60 |
| 810070 | 50 | 1/6/60 |
| 810071 | 63 | 1/6/60 |



**C Curve
Three Pole**

| Cat. Nos. | Rating (A) | Pack |
|-----------|------------|--------|
| 810081 | 6 | 1/4/40 |
| 810082 | 10 | 1/4/40 |
| 810083 | 16 | 1/4/40 |
| 810084 | 20 | 1/4/40 |
| 810085 | 25 | 1/4/40 |
| 810086 | 32 | 1/4/40 |
| 810087 | 40 | 1/4/40 |
| 810088 | 50 | 1/4/40 |
| 810089 | 63 | 1/4/40 |



**C Curve
Double Pole**

| Cat. Nos. | Rating (A) | Pack |
|-----------|------------|--------|
| 810072 | 6 | 1/6/60 |
| 810073 | 10 | 1/6/60 |
| 810074 | 16 | 1/6/60 |
| 810075 | 20 | 1/6/60 |
| 810076 | 25 | 1/6/60 |
| 810077 | 32 | 1/6/60 |
| 810078 | 40 | 1/6/60 |
| 810079 | 50 | 1/6/60 |
| 810080 | 63 | 1/6/60 |



**C Curve
Three Pole Neutral**

| Cat. Nos. | Rating (A) | Pack |
|-----------|------------|--------|
| 810090 | 6 | 1/3/30 |
| 810091 | 10 | 1/3/30 |
| 810092 | 16 | 1/3/30 |
| 810093 | 20 | 1/3/30 |
| 810094 | 25 | 1/3/30 |
| 810095 | 32 | 1/3/30 |
| 810096 | 40 | 1/3/30 |
| 810097 | 50 | 1/3/30 |
| 810098 | 63 | 1/3/30 |

Miniature Circuit Breaker - MCB



**C Curve
Four Pole**

| Cat. Nos. | Rating (A) | Pack |
|-----------|------------|--------|
| 810099 | 6 | 1/3/30 |
| 810100 | 10 | 1/3/30 |
| 810101 | 16 | 1/3/30 |
| 810102 | 20 | 1/3/30 |
| 810103 | 25 | 1/3/30 |
| 810104 | 32 | 1/3/30 |
| 810105 | 40 | 1/3/30 |
| 810106 | 50 | 1/3/30 |
| 810107 | 63 | 1/3/30 |

Isolator • Confirms to IS / IEC 60947-3 • Bi-Connect Terminals • Positive Isolation
• Degree of Protection IP 20 • 25 sq. mm Terminals

Double Pole



| Cat. Nos. | Rating (A) | Pack |
|-----------|------------|--------|
| 810130 | 40 | 1/6/60 |
| 810131 | 63 | 1/6/60 |

Three Pole



| Cat. Nos. | Rating (A) | Pack |
|-----------|------------|--------|
| 810132 | 40 | 1/4/40 |
| 810133 | 63 | 1/4/40 |

Four Pole



| Cat. Nos. | Rating (A) | Pack |
|-----------|------------|--------|
| 810134 | 40 | 1/3/30 |
| 810135 | 63 | 1/3/30 |

Residual Current Circuit Breaker - RCCB

- Confirms to IS 12640 -1 & IEC 61008 -1
- Degree of Protection IP 20
- Bi-Connect Terminals
- Short Circuit Withstand Capacity of 6kA
- 25 sq. mm Terminals
- CE marked



Double pole

| Cat. nos. | Rating (A) | Sensitivity | Pack |
|-----------|------------|-------------|------|
| 810150 | 25 | 30 mA | 1/80 |
| 810153 | 25 | 100 mA | 1/80 |
| 810156 | 25 | 300 mA | 1/80 |
| 810151 | 40 | 30 mA | 1/80 |
| 810154 | 40 | 100 mA | 1/80 |
| 810157 | 40 | 300 mA | 1/80 |
| 810152 | 63 | 30 mA | 1/80 |
| 810155 | 63 | 100 mA | 1/80 |
| 810158 | 63 | 300 mA | 1/80 |



Four Pole

| Cat. nos. | Rating (A) | Sensitivity | Pack |
|-----------|------------|-------------|------|
| 810159 | 25 | 30 mA | 1/48 |
| 810162 | 25 | 100 mA | 1/48 |
| 810165 | 25 | 300 mA | 1/48 |
| 810160 | 40 | 30 mA | 1/48 |
| 810163 | 40 | 100 mA | 1/48 |
| 810166 | 40 | 300 mA | 1/48 |
| 810161 | 63 | 30 mA | 1/48 |
| 810164 | 63 | 100 mA | 1/48 |
| 810167 | 63 | 300 mA | 1/48 |



Indoasian's network of channel partners and distributors span 60 countries in Africa, Middle East, Far East, Asia Pacific, Europe and Oceania.



CORPORATE OFFICE:

V. J. Business Towers, A-6, 1st Floor,
Sector-125, Noida-201301, U.P., India.

Tel.: +91-0120-3305100

E-mail: international@indoasian.com

Website: www.indoasian.com

WARRANTY:

IA products carry a warranty against manufacturing defects, subject to use of the product for the right application, with correct wiring/connection and normal operating conditions. Please refer to detailed Indo Asian warranty policy effective 1st April 2008.

MCBs 36 months* Isolator 36 months* RCCBs 18 months* DBs 2 months*

**From the date of manufacture.*

CHANNEL PARTNER: